

Enclosed LED Inside an Aluminum Channel with Diffusion Lens 285 lumens/foot @ 3.9 watts - CRI 97

PROJECT	TYPE	CATALOG NUMBER
---------	------	----------------

Fixture Description: A high CRI, continuous power LED dimmable light strip shallow mounted (5/8") inside an aluminum channel extrusion (maximum 12' run per feed) at a huge savings over incandescent or halogen. Runs cooler than incandescent or halogen, and contains no harmful gasses. Supplied with an acrylic diffuser. 50,000 hour lamp life saves on maintenance and re-lamping costs. High CRI provides superior color rendition for food items in the kitchen and skin tones in the bath / vanity area. 5 year warranty.

Construction: 28 LED diodes per foot wired into rigid LED channel attached to an aluminum extrusion with snap-on diffuser.

Diffuser: Diffused extruded lens.

Electrical: 24 Volt DC. 3.9 Watts per foot. 285 lumens per foot.

Dimmable. Remote Class II constant voltage 24V driver required.

Dimming: NOTE: Use reverse phase dimming with neutral.

Mounting: Mounts into coves, under cabinets, bookshelves, or other surfaces with screws. 3/16" holes in back or end cap with bracket.

Label: ETL

Applications:

- Any interior application where color rendition is key, including
- Under cabinet lighting • Closets • Task lighting • Coves • Light Pockets
- Accent Lighting • Restaurants • Bedroom • Hospitality • Suites
- Health care • Themed areas

Please consult our website for any updated specifications on this product:
www.dreamscapelighting.com

Remote Power Supplies

DL-LTF 2496-DIM-RE-96	96W Maximum 16' LED board per home run.
DL-LTF 2460-DIM-RE-60	60W Maximum 10' LED board per home run.

LED Specifications

Voltage	24V DC
Watts	3.9 Watts
Lumens per Foot	LED: 356 / FIXTURE: 285
CRI:	97 (for 3K90 board only)
Color Temp.:	3K-90, 27K-90
Beam Spread	120°
Maximum Run per Feed	12'
Maximum Single Length	46"
Mounting	Attached to extrusion
Warranty	5 year / 50,000 Hrs. (in an environment that reaches no higher than 105°F) NOTE: Please contact factory regarding warranty if fixture is exposed to higher ambient temperatures.

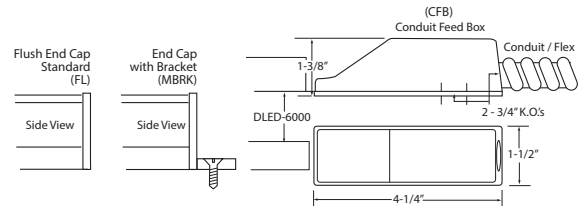
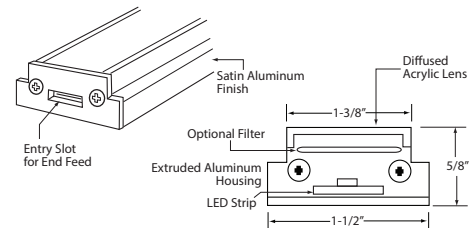
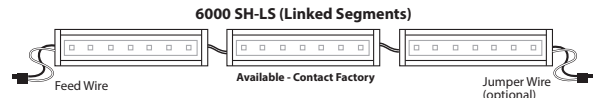
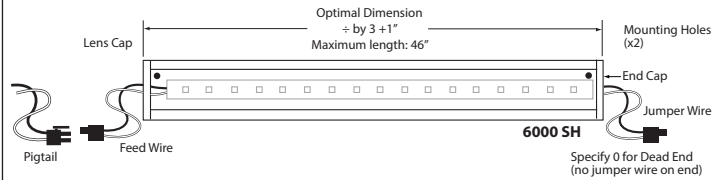

Secondary Wire Spec

Maximum Load	96W
Maximum Distance	50 feet
Wire	12AWG 2/C Type CM-CL2
	ETL-CM CL3
	Standard copper conductor

Model Number	Fixture Length	Feed Wire	Jumper Wire	End Cap	Finish	Color Temp.	Pigtail
DLED-6000SH	7", 10", 13", 16", 19", 22", 25", 28", 31", 34", 37", 40", 43", 46"	6", 1', 2', 3', 4', 5', 6'	6", 1', 2', 3', 4', 5', 6' 0 (dead end for end of run)	FL Flush Mount MFRK Mounting Bracket	SA Satin Aluminum Clear Kit BL Black WH White CU Custom	3K-90 27K-90	6", 1', 2', 3', 4', 5', 6'

Ordering Example: **DLED-6000SH-37"-6"-0-FL-SA-3K-90-6"**